

1 2 3 4 5 6 7 8

A
B
C
D
E
F
G
H

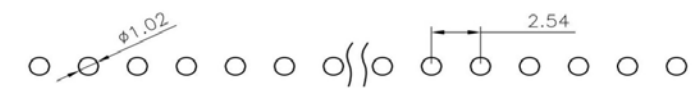
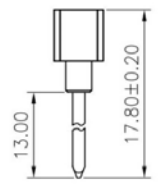
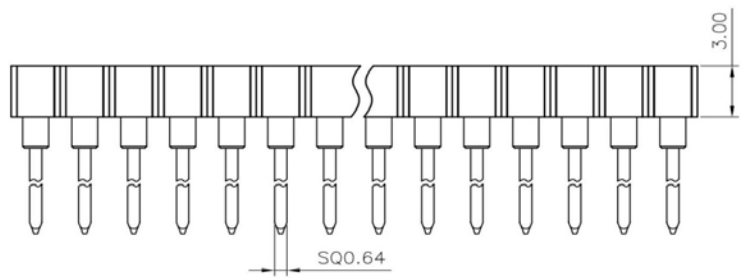
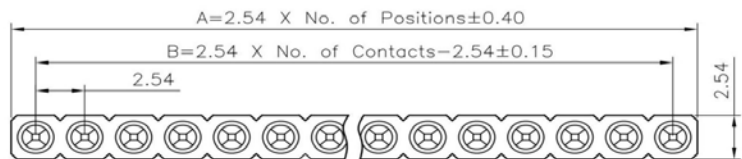

P.C.B LAYOUT

Technical Data

Material:
 Pin(outer sleeve): Brass,machined CuZn38Pb2
 Clip(contact 4 finger): Beryllium copper,heat treated
Plating(outer sleeve):
 Tin plated:2µm/80µ"Ni, 5µm/200µ"Sn
 Gold Plated:2µm/80µ"nickel full gold
Plating(contact): 2µm/80µ"nickel, gold or Tin plated
Insulator black(housing): PPS (UL94V-0)

Electrical:
 Current rating: 3Amps/contact max.
 Contact resistance: ≤4mΩ/contact
 Insulation resistance: ≥1000MΩ at V=100V
 Operating voltage: 60VAC/DC

Mechanical:
 Average insertion force with steel pin of
 □0.43mm/0.17": <250g
 Average withdrawal force with steel pin of
 □0.43mm/0.17": >50g min.
 Mechanical life cycle:min.200
 Operating temperatures: Gold Plated:-55°C to+105°C
 Tin plated:-40°C to+105°C
 Soldering temperature: +260°C,10s max

RoHS Compliant			
APPD. 核准 BETTY	 SCALE 比例 参考	TOLERANCE ANGLE ±5° N-DIM ±0.05 N-N ±0.10 N-S ±0.15 S ±0.20	PART NAME 品名 2.54mm SIP SOCKET MACHINED PIN 4 FINGERED CLIP 1XXXP PIN:TIN CLIP:GOLD PLATING WIRE WRAP PIN
DWG. 製圖 BETTY			
DATE 制表日 2009/11/16	PAGE 張數 1 OF 1	REV. 版次 A	PART NO. 料號 SIP40WW

1 2 3 4 5 6 7 8