

MEC

RS REED SWITCH

General purpose Rhodium plated miniature Reed Switch. Applications including sensing elements used in safety and security systems, level sensing, counting and miniature relays.

PHYSICAL CHARACTERISTICS (mm) DIMENSIONS

| | |
|----------------|-------------|
| Glass Diameter | 2.3 (max.) |
| Glass Length | 14.2 (max.) |
| Lead Diameter | 0.6 (typ.) |
| Overall Length | 44.7 (max.) |

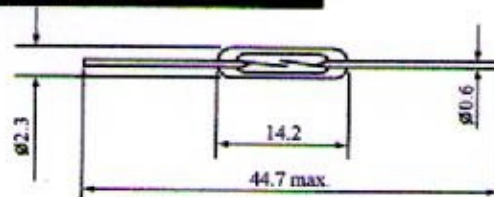

Glass Appearance : Green Transparent
LEAD : GOLD PLATING

ELECTRICAL CHARACTERISTICS

| | |
|------------------------|----------------------------|
| Contact Arrangement | SPST Form A Centre gap. |
| Contact Material | Rhodium |
| (1) Power Rating | 10 W |
| Switching Current | 0.5 ADC 0.5 AAC max. |
| Carrying Current | 1.0 ADC 1.0 AAC max. |
| Switching Voltage | 100 VDC 125 VAC - RMS max. |
| (2) Breakdown Voltage | 250 VDC |
| (3) Contact Resistance | 100 mΩ max. |
| Insulation Resistance | 10 ¹⁰ Ω min. |
| Contact Capacitance | 0.7 pF max. |

OPERATING CHARACTERISTICS

| | |
|-------------------------------|------------------|
| Operate Time including Bounce | 0.6 ms (typ.) |
| Release Time | 0.1 ms (typ.) |
| Resonant Frequency | 5.3 kHz (typ.) |
| Vibration 10 - 2,000 Hz | 50 G max. |
| Shock - 11ms, 1/2 Sine Wave | 100 G max. |
| Operating Temperature | -40 °C ~ +125 °C |
| Storage Temperature | -50 °C ~ +155 °C |
| Pull-In Range | 10 AT ~ 15 AT |
| Drop-Out | 5 AT ~ 10 AT |

NOTES:

- (1) The specification for VA Rating may be exceeded for less sensitive (high AT) switches, and should be decreased for very sensitive (low AT) switches. Specific life testing for a particular load will be run upon request.
- (2) Breakdown voltage is measured in the presence of a radioactive ionizing source with switch leakage current limited to 100 mA.
- (3) Contact resistance measurements are made at 10mA from a 1 volt source with 15AT overdrive using a 4 wire (Kelvin) measuring system and contact probes located on 1.7" centers.

TEST COIL : NUMBER OF TURNS : 5,000
RESISTANCE OF COILS : 870 Ω

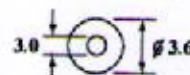
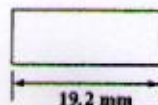

BIN COOE : 14103