

**Technical Data**

**ELECTRICAL**

Voltage Rating : 125 VAC RMS Min.  
Current Rating : 1.5 AMP Min.  
Contact Rating : 30 Mini Ω Max.  
Insulation Resistance : 500 Meg Ω Min @ 500 VDC.  
Dielectric Strength : 1000 VAC RMS 60 Hz, 1Min.

**MECHANICAL**

Housing Material : Glass Filled Polyester UL94V-0  
Contact Material : Phosphor Bronze Ø0.46mm  
Plating : Gold plating over Nickel  
Operating Life : 250 Cycles Min.  
PCB Retention pre-solder : 1 LB Min.  
PCB Retention Post-solder : 10 LBS Min.

**ENVIRONMENTAL**

Storage : -40°C to +85°C  
Operation : 0°C to 70°C  
Mates with modular plug conforming to  
FCC part 68, subpart F.

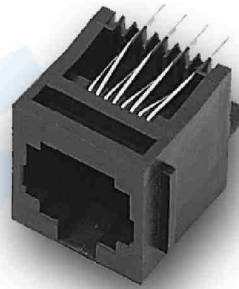

850-F88-04

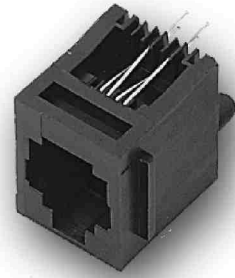

850-F64-04

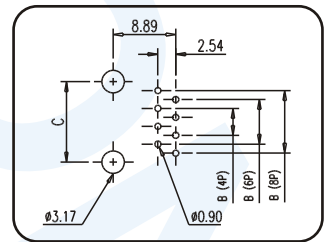
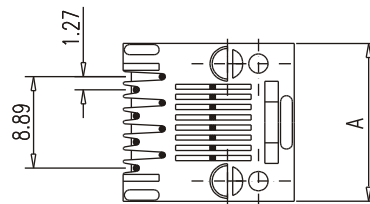
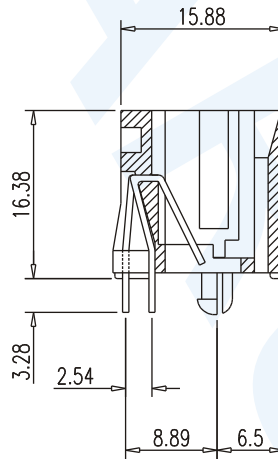

PC Board Layout

**HOW TO ORDER**

Position	Dimension		
	A	B	C
4	11.43	3.81	7.62
6	13.46	6.35	10.16
8	15.36	8.89	11.43

Unit = mm

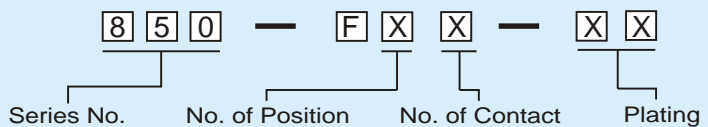

01	15 μm	03	50 μm
02	30 μm	04	6 μm

All specification change without prior notice