

REV.	DESCRIPTION	DRAWN	CHECKED	APPROVED
A	NEW RELEASE	HP 15/06/05		

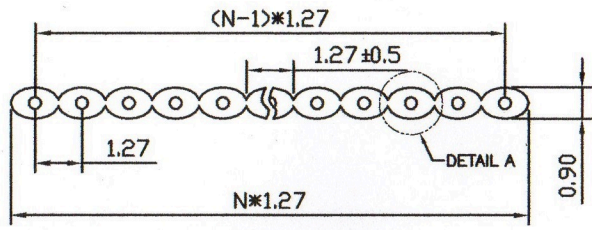

N=Positions

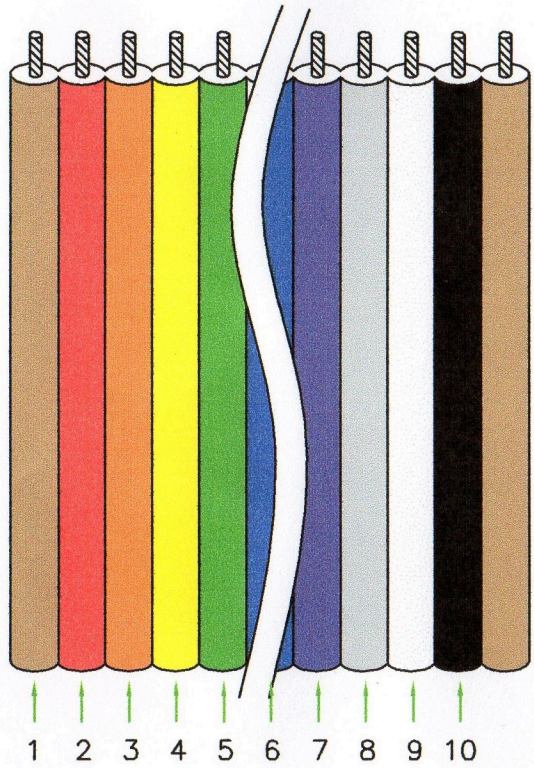
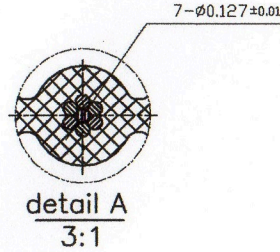

Pin	Cable color	Pin	Cable color
1	Brown	6	Blue
2	Red	7	Purple
3	Orange	8	Gray
4	Yellow	9	White
5	Green	10	Black

NOTES:

- Color
.Insulation: MULTI COLOUR
- SPECIFICATION
. Rating: 300V 1A
. Conductor Size: 28AWG
. Insulation resistance: 100MΩ/km min.
. Dielectric withstanding voltage: 1000 VAC 1 minute.
. Temperature range: -20°C to +80°C.
- APPLICATION
. Internal wiring of computers, electronic exchanges, measurement control devices, business machines, communication devices, and other electronic equipment.

4. Product Number Code

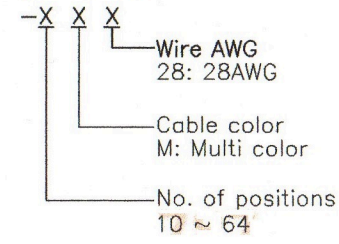

GENERAL TOLERANCE		ANGLE TOLERANCE		PROJECTION		TITLE	FLAT CABLE MUTLI COLOR	
X.	±0.60	X.	±5°	UNITS	mm			
.X	±0.38	.X	±3'	SHEET SIZE	A4	SERIES		
.XX	±0.25	.XX	±2'	COLxx				
DRAWING TYPE		CUSTOMER						
SCALE		1:1	SHEET 1 OF 1					
DRAWING NO.								