

| REV. | DESCRIPTION | DRAWN       | CHECKED | APPROVED |
|------|-------------|-------------|---------|----------|
| A    | NEW RELEASE | HP 15/06/05 |         |          |
|      |             |             |         |          |
|      |             |             |         |          |

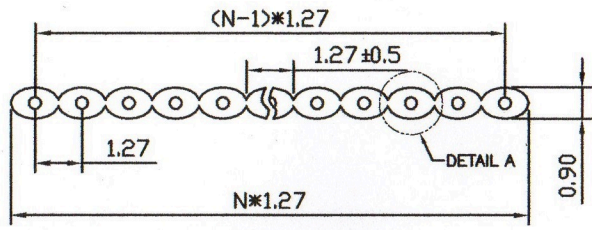

N=Positions

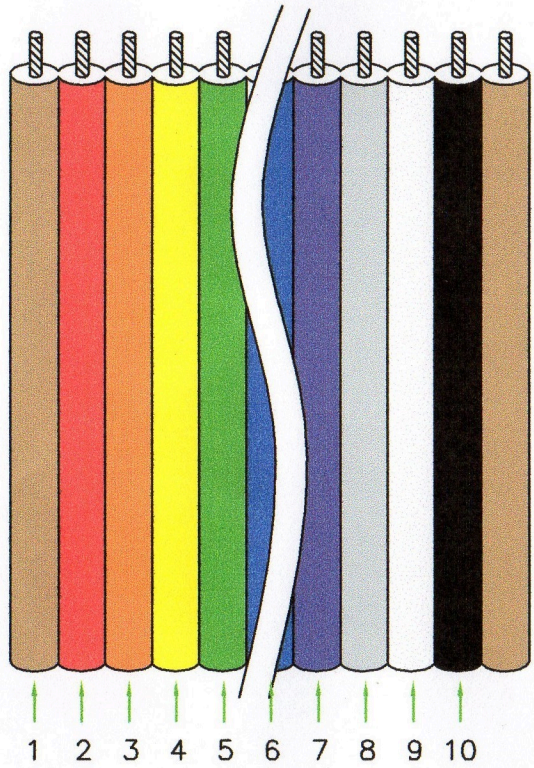
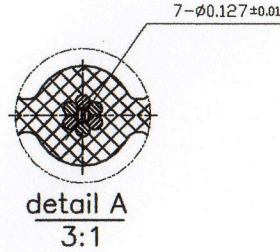

| Pin | Cable color | Pin | Cable color |
|-----|-------------|-----|-------------|
| 1   | Brown       | 6   | Blue        |
| 2   | Red         | 7   | Purple      |
| 3   | Orange      | 8   | Gray        |
| 4   | Yellow      | 9   | White       |
| 5   | Green       | 10  | Black       |

NOTES:

- Color  
.Insulation: MULTI COLOUR
- SPECIFICATION  
. Rating: 300V 1A  
. Conductor Size: 28AWG  
. Insulation resistance: 100MΩ/km min.  
. Dielectric withstanding voltage: 1000 VAC 1 minute.  
. Temperature range: -20°C to +80°C.
- APPLICATION  
. Internal wiring of computers, electronic exchanges, measurement control devices, business machines, communication devices, and other electronic equipment.

4. Product Number Code

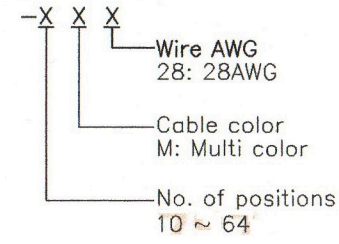

| GENERAL TOLERANCE |       | ANGLE TOLERANCE |              | PROJECTION | TITLE                  |        |
|-------------------|-------|-----------------|--------------|------------|------------------------|--------|
| X.                | ±0.60 | X.              | ±5°          |            | FLAT CABLE MUTLI COLOR |        |
| .X                | ±0.38 | .X              | ±3°          | UNITS      | mm                     |        |
| .XX               | ±0.25 | .XX             | ±2°          | SHEET SIZE | A4                     | SERIES |
| DRAWING TYPE      |       | CUSTOMER        |              | COLxx      |                        |        |
| SCALE             |       | 1:1             | SHEET 1 OF 1 |            |                        |        |
| DRAWING NO.       |       |                 |              |            |                        |        |